

# xari

user manual & warranty





Dear parents, grandparents, and friends,

Thank you for choosing **xari** and making it part of your family!

We have designed and developed our products carefully, keeping in mind the comfort and safety for you and your child. We hope you will enjoy using **xari**.

Please read these instructions with care before using it for the first time. This will enable you to appreciate all features and will ensure a safe usage

mima

CONTENTS

WHAT YOU GET .....	3
PAY ATTENTION .....	4
GETTING STARTED .....	5
FIRST SETUP	
WHEELS	
HANDLEBAR HEIGHT	
FOLDING AND UNFOLDING	
PARKING BRAKE	
PHASE 1: BABY .....	7
CARRYCOT	
PHASE 2: TODDLER .....	8
SAFETY HARNESS	
SEAT	
ACCESSORIES .....	9
SAFETY BAR	
CANOPY	
APRON	
RAIN COVER	
CARE AND MAINTENANCE .....	11
WARRANTY .....	12

WHAT YOU GET

You have received two boxes. Please check if all parts listed below are in there. If anything is missing, please contact your supplier.

Hardware box:

- 1 chassis with 2 baskets attached
- 1 seat with carrycot inside
- 1 canopy
- 2 front wheels
- 2 rear wheels
- 1 rain cover

Softgoods starter box:

- 1 seat pad with safety harness
- 1 carrycot apron
- 1 carrycot mattress

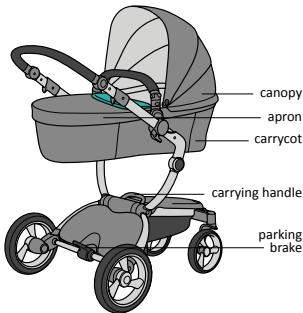
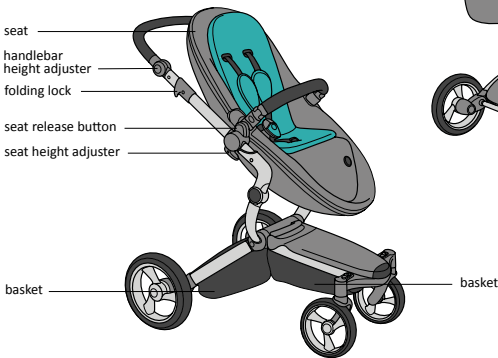

## PAY ATTENTION

### IMPORTANT!

- Read these instructions carefully before use and keep them for future reference. Your child's safety may be affected if you do not follow these instructions.
- This stroller is intended for children from birth and up to 17 kg. When used for children under the age of 6 months we recommend to use the supplied carrycot until the child can sit unaided.
- This stroller can be used for transporting a maximum of one child at a time. The recommended maximum load is 17 kg.
- The maximum permitted weight in each of the two baskets is 3 kg.

### WARNINGS!

- A child's safety is your responsibility.
- It may be dangerous to leave your child unattended.
- Ensure that all the locking devices are engaged before use.
- Do not add a mattress thicker than 20 mm. Do not add an additional mattress in the carrycot, only use the one provided by **mima**.
- As soon as your child can sit in the seat unaided make sure to always use the safety harness. Ensure the harness is fitted correctly to prevent the risk of your child sliding or falling out.
- The seat is not suitable for children under 6 months.
- Any load attached to the handle affects the stability of **xari** and increases the risk of it tipping over accidentally.

- Always use the crotch strap in combination with the waist belt.
- This product is not suitable for running or skating.
- Do not stand on the crossbars between the wheels. This is unsafe and may damage the stroller.
- Check that the carrycot and/or seat are installed correctly and securely locked in place before usage.
- Always apply the brake when standing still even for only a few moments! Apply brake when loading or unloading children.
- Make sure children are clear of any moving parts before making adjustments or folding/unfolding stroller. Ensure that fingers are kept away from the folding mechanism when folding the stroller.
- Do not use the stroller if any parts are damaged or missing. It may be unsafe to use replacement parts that are not supplied by **mima**.

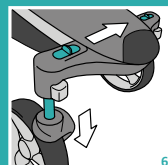
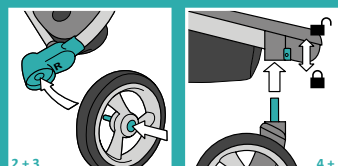
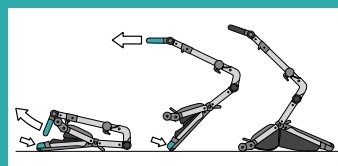

## GETTING STARTED

### FIRST SETUP

#### 1. Unfold chassis

Pull up the handlebar while holding down the tip of the chassis with your foot. Continue to pull the handlebar towards you until the chassis completely unfolds and stands by itself.

### WHEELS

- Please note the L/R indication on the chassis and on each wheel.

#### 2. Attach rear wheels

Press in the wheel axle hub and insert the axle into the wheel fitting.

Check if the wheels are properly attached by attempting to pull them out again.

#### 3. Remove rear wheels

Press in the wheel axle hub and pull out the wheel.

#### 4. Attach front wheels

Insert the wheel rod into the wheel fitting and push in until it clicks.

#### 5. Front wheel swivel lock

Use the front wheel swivel lock when you are using **xari** on rough terrain.

Push down the swivel lock button to activate. Pull it up again to deactivate.

#### 6. Remove front wheels

Slide the unlock button sideways and pull out the front wheel.

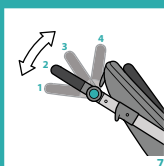

#### HANDLEBAR HEIGHT

##### 7. Adjust handlebar height

Press and hold both buttons located on the outside of the handlebar and rotate the handlebar into the desired position.

#### FOLDING AND UNFOLDING

- **WARNING:** Child should not be near to the stroller when folding or unfolding!
- Ensure the brake is on while folding and unfolding the chassis. Not doing so might cause damage to the seat.

##### 8. Unfold chassis

Pull the handlebar upwards and continue to pull it towards yourself until the chassis completely unfolds and stands by itself.

Rotate the handlebar into the desired position.

##### 9. Fold chassis (with seat attached)

- *xari* can be folded with the seat attached (i.e. in its upright position and forward facing).
  - *xari* cannot be folded with the carrycot attached.
- Rotate the handlebar into position 4 (see fig. 7). Push down the safety button and pull the two folding locks upwards, then lower the handlebar. Grab the chassis at the two hinge parts and pull it upwards so the front fork folds down. Let the chassis stand and rest onto the front wheels. To transport the chassis grab the carrying handle.

#### PARKING BRAKE

- **WARNING:** Always use the brake even when standing still for only a few moments!

##### 10. Apply and release parking brake

Press down the brake pedal to park. Press it down again to release.

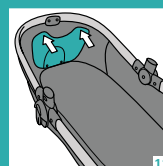
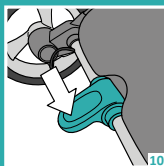

#### PHASE 1: BABY

##### CARRYCOT

- When using *xari* for children under the age of 6 months, we recommend using the supplied carrycot until the child can sit unaided.

##### 11. Set up carrycot

Zip open the seat and take out the carrycot. Push the two flaps underneath the carrycot tube. Place the mattress inside the carrycot and attach the safety bar (see fig. 25).

##### 12. Adjust carrycot angle

It is easier to fit the carrycot onto the chassis if the attachment brackets are in position III, pointing straight downwards. To achieve this pull the angle adjustment lever and rotate the brackets. The carrycot angle can also be adjusted when fitted to the chassis.

##### 13. Attach carrycot

Position the carrycot so that the angle adjustment lever is at the front end of the stroller. Lower the carrycot onto the chassis until it clicks in place.

##### 14. Remove carrycot

Press the two buttons on both sides of the carrycot and lift it up.

##### 15. Adjust height of carrycot

- There are two height positions for the carrycot.
- Press the height adjustment buttons on both sides of the chassis and move the carrycot up or down.

##### 16. Collapse carrycot

Remove the mattress and the safety bar. Release the sideflaps from the carrycot frame. Open the seat and position the collapsed carrycot inside the seat. Align the angle adjustment lever with the hole in the rear shell of the seat. Make sure the seat brackets stay out of the seat.

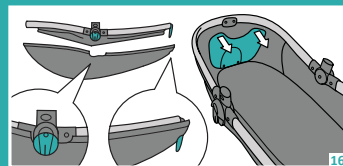
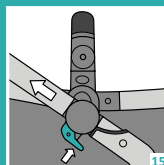
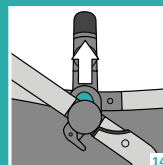
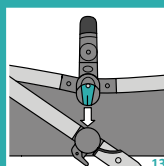
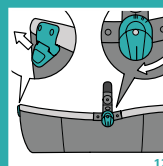

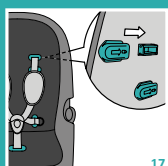

17

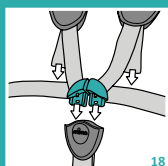

18

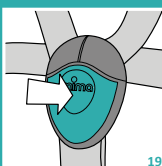

19

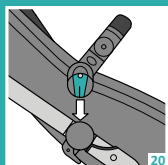

20

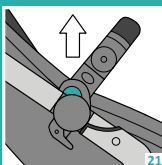

21

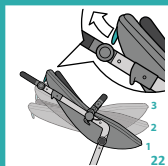

22

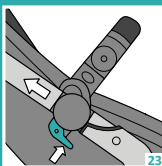

23

## PHASE 2: TODDLER

### SAFETY HARNESS

- Whenever a child is placed in the seat, ensure that the safety harness is correctly fitted.
- The shoulder straps can be set at two different height positions. Choose the position closest to the top of the child's shoulders.

#### 17. Set up harness

Take each harness attachment and slide off the bottom part. Push the harness attachment through its corresponding hole in the seatpad and the seat. Zip open the seat and slide the bottom part onto the harness attachment from the inside of the seat until it clicks in place.

#### 18. Buckle up

Push the shoulder strap buckles into the buckle slot until it clicks. Pull the loose ends on the shoulder straps to fit the harness snugly around the child.

#### 19. Buckle down

Push the central buckle button to release the harness.

### SEAT

- The seat is suitable for children from the age of 6 months and up to 17 kg.
- The seat can be attached either forward facing or backward facing.

#### 20. Attach seat

Lower the seat onto the chassis until it clicks in place.

#### 21. Remove seat

Press the two seat release buttons on both sides of the seat and lift it up.

#### 22. Adjust seat angle

Pull up the lever on the top of the seat, and rotate the seat into the desired angle.

#### 23. Adjust height of seat

- There are two height positions for the seat.
- Press the height adjustment buttons on both sides of the chassis and move the seat up or down.

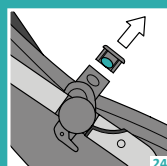

24

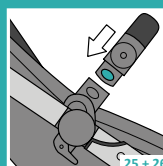

25 + 26

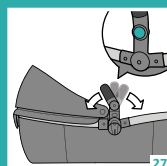

27

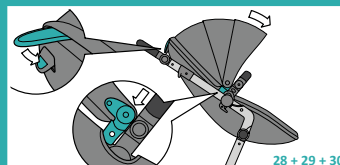

28 + 29 + 30

## ACCESSORIES

### SAFETY BAR

- Always use the safety bar for the safety of your child.

#### 24. Remove safety bar covers

Push in the buttons and slide the covers off. Keep the covers in a safe place for future use.

#### 25. Attach safety bar

While pressing the two buttons on the outside of the bumper bar, push it down onto the seat frame, until it clicks.

Check if the bumper bar is properly attached by attempting to pull it out again.

#### 26. Remove safety bar

Press the buttons on the outside of the bumper bar, and pull it up.

#### 27. Adjust safety bar angle

While pressing the two buttons on the inner side of the safety bar, rotate it to the desired angle.

### CANOPY

- The canopy can be fixed to both the seat as well as the carrycot.
- When the canopy becomes wet, keep it open and let it dry before closing it.

#### 28. Attach canopy to seat or carrycot

Push the canopy clips onto the seat frame until they click in place.

Fix the velcro flap to the seat.

#### 29. Open/close canopy

Pull the canopy flaps to open.

Push down the canopy flaps to close.

#### 30. Remove canopy

Release the velcro flap at the top of the canopy

Pull the canopy clips outwards and pull them up to remove them from the seat frame.

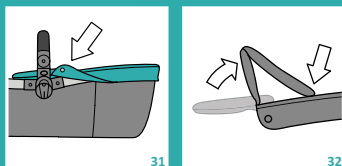

31

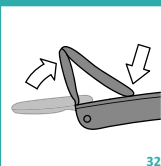

32

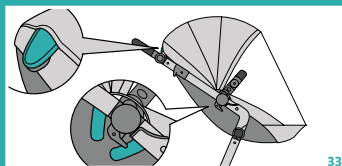

33

#### APRON

##### 31. Attach apron to carrycot

Place the apron over the carrycot frame. Click the snap buttons on both sides of the apron onto the studs of the carrycot frame.

##### 32. Adjust apron

The upper apron flap can be placed into two different positions, which are magnetized.

#### RAIN COVER

- The rain cover can be fixed to both the seat as well as the carrycot.
- Make sure you attach the canopy first.

##### 33. Attach rain cover to seat or carrycot

Fully open the canopy. Position the rain cover over the canopy so the rotation lever goes through the hole in the raincover. Stretch the rain cover over the seat or carrycot and fix the velcro straps around the seat brackets.

#### OTHER ACCESSORIES

We develop new accessories for *xari* frequently. For more details please check [www.mimakids.com](http://www.mimakids.com) or with your supplier.

The following accessories are already available and can be purchased separately:

- Footmuff
- Mosquitonet
- Adapter kit (Maxi Cosi Cabrio, Cybex Aton, Bébé Confort Pebble)

## CARE AND MAINTENANCE

- To keep *xari* in perfect condition please go through the following steps regularly.
- Fabrics and plastics conform to the highest grade of colourfastness. But excessive exposure to the sun can cause premature fading of plastics and fabrics.

#### CHASSIS CLEANING

Wash off sand and salt after visiting the beach. Brush off excessive dirt. Then wipe clean with a moist cloth and a mild cleaning agent.

#### LUBRICATING MOVING PARTS

Periodically lubricate the wheels, hinges and other sliding parts using a light oil or silicon spray. Do not use heavy oil as this will attract dust and grit which tend to clog and damage moving parts.

#### SEAT CLEANING

The rigid seat can be wiped clean with a moist cloth and a mild cleaning agent. More resistant marks can be rubbed away using a pencil eraser.

The seat cushion and shoulder pads can be removed (see [fig. 17](#)) and must be washed by hand.

Please note the following:

- maximum temperature 30°C / 85°F
- do not bleach
- do not tumble dry
- do not iron
- do not dry clean.

#### CHECK OTHER PARTS

From time to time check *xari* for loose screws, worn parts, torn material and loose stitching. Contact your retailer if parts need to be replaced or repair the parts as needed.

## WARRANTY

### REGISTER YOUR PRODUCT ONLINE AT [WWW.MIMAKIDS.COM](http://WWW.MIMAKIDS.COM)

This will activate your warranty and will allow us to keep you informed on possible product updates.

Your product complies with current safety requirements and is guaranteed to be free from manufacturing defects in workmanship and material at time of purchase.

If this product shows material and/or manufacturing defects after purchase and during the warranty period (with normal use as described in the user manual), then please contact your retailer.

### WARRANTY CONDITIONS

- The warranty period is 24 months from the date of purchase. This warranty period is not extended, even in the event of repair.
- For the warranty to be valid you need to:
  1. have your product registered online at [www.mimakids.com](http://www.mimakids.com)
  2. provide the original purchase receipt to your retailer
  3. provide a description of the defect to your retailer.
- The warranty is made to the original owner of the product and is not transferable to any subsequent owner.
- The warranty provides a right to repair and specifically not to a product's exchange or return.

The warranty does not apply in the following circumstances:

- The product has been modified or repaired by third parties.
- Corrosion or rust on the wheels and chassis due to extreme environmental conditions, including high humidity, salt spray, ice or snow or due to insufficient maintenance.
- The defect was caused by improper usage or maintenance or due to anything else deemed to be the fault of the user; in particular, failure to comply with the instructions for use as described in the user manual.
- The defect was caused as the result of an accident or airline/ transport damage.
- Normal wear and tear that can be expected with daily use of this product.
- Discoloration or damage to the fabric due to washing, rainwater, or excessive exposure to sunlight.
- The defect is the result of overloading (exceeding the maximum weight allowance for the child and any items being carried).

[www.mimakids.com](http://www.mimakids.com)

All right reserved © Mima Europe S.L. 2010