

# Settings Guide

This settings guide **should only be used as general reference.**  
 After some uses, you will learn what settings will work best for your bottles.  
**Always test bottle temperature before feeding baby.**

# babyprezza®

## Quick Warm

🏠 Room Temperature 70°F / 21°C

Plastic Bottle		Glass Bottle	
1oz / 30ml	setting 1	1oz / 30ml	✗
2oz / 60ml	setting 2	2oz / 60ml	✗
3oz / 90ml	setting 3	3oz / 90ml	setting 1
4oz / 120ml	setting 4	4oz / 120ml	setting 2
5oz / 150ml	setting 5	5oz / 150ml	setting 3
6oz / 180ml	setting 6	6oz / 180ml	setting 4
7oz / 210ml	setting 7	7oz / 210ml	setting 5
8oz / 240ml	setting 8	8oz / 240ml	setting 6
9oz / 270ml	setting 9	9oz / 270ml	setting 6

## Quick Warm

❄️ Cold Temperature REFRIGERATED 39°F / 4°C

Plastic Bottle		Glass Bottle	
1oz / 30ml	setting 1	1oz / 30ml	✗
2oz / 60ml	setting 2	2oz / 60ml	✗
3oz / 90ml	setting 3	3oz / 90ml	setting 1
4oz / 120ml	setting 4	4oz / 120ml	setting 2
5oz / 150ml	setting 5	5oz / 150ml	setting 3
6oz / 180ml	setting 6	6oz / 180ml	setting 3
7oz / 210ml	setting 7	7oz / 210ml	setting 4
8oz / 240ml	setting 8	8oz / 240ml	setting 5
9oz / 270ml	setting 9	9oz / 270ml	setting 6

bottle + breastmilk warmer

Instructions for set-up, use and cleaning



## Steady Warm

🏠 Room Temperature 70°F / 21°C

Plastic Bottle		Glass Bottle	
1oz / 30ml	setting 1	1oz / 30ml	✗
2oz / 60ml	setting 2	2oz / 60ml	setting 1
3oz / 90ml	setting 3	3oz / 90ml	setting 2
4oz / 120ml	setting 4	4oz / 120ml	setting 4
5oz / 150ml	setting 5	5oz / 150ml	setting 4
6oz / 180ml	setting 6	6oz / 180ml	setting 5
7oz / 210ml	setting 7	7oz / 210ml	setting 7
8oz / 240ml	setting 8	8oz / 240ml	setting 7
9oz / 270ml	setting 9	9oz / 270ml	setting 7

## Steady Warm

❄️ Cold Temperature REFRIGERATED 39°F / 4°C

Plastic Bottle		Glass Bottle	
1oz / 30ml	setting 1	1oz / 30ml	✗
2oz / 60ml	setting 2	2oz / 60ml	setting 1
3oz / 90ml	setting 3	3oz / 90ml	setting 2
4oz / 120ml	setting 4	4oz / 120ml	setting 3
5oz / 150ml	setting 5	5oz / 150ml	setting 4
6oz / 180ml	setting 6	6oz / 180ml	setting 5
7oz / 210ml	setting 7	7oz / 210ml	setting 6
8oz / 240ml	setting 8	8oz / 240ml	setting 7
9oz / 270ml	setting 9	9oz / 270ml	setting 7

# IMPORTANT SAFEGUARDS

When using electrical appliances, basic safety precautions should be followed, including the following:

1. Read all instructions before using.
2. Do not touch hot surfaces. Use handles.
3. To protect against electric shock and injury to persons do not immerse cord, plug, water tank or appliance in water or other liquid.
4. Close supervision is necessary when any appliance is used by or near children.
5. Unplug from outlet when not in use and before cleaning. Allow to cool before inserting or removing parts, and before cleaning the appliance.
6. Do not operate this appliance with a damaged cord or plug. If the appliance malfunctions or has been damaged in any manner, return appliance to the nearest authorized service facility for examination, repair or adjustment.
7. The use of accessory attachments not recommended by the appliance manufacturer may cause fire, electric shock or injury.
8. Use on level surface and be sure there is no debris under the unit and the rubber pads are touching the surface.
9. Household use only. Do not use outdoors.
10. Do not let cord hang over edge of table or counter, or touch hot surfaces.
11. Extreme caution must be used when moving an appliance containing hot liquids.
12. Do not place on or near hot gas or electric burner, or in a heated oven.
13. Do not use appliance for other than intended use.
14. This appliance has a polarized plug (one blade wider than the other). To reduce risk of electric shock, this plug is intended to fit into a polarized outlet only one way. If the plug does not fit fully into the outlet, reverse the plug. If it still does not fit, contact a qualified electrician. Do not attempt to modify the plug in any way.
15. To disconnect, turn appliance off, then remove plug from wall outlet.
16. Make sure machine is turned off before unplugging.
17. A short power-supply cord is provided to reduce risks of becoming entangled in or tripping over a longer cord. Longer detachable power-supply cords or extension cords are available and may be used if care is exercised in their use. If using the machine with an extension cord, make sure the cord is the proper electrical rating for the machine.
18. The extension cord should be arranged so that it does not drape over a counter top or tabletop, where it can be pulled on by children or tripped over unintentionally.
19. Before serving make sure food is at safe temperature for baby.
20. Unplug cord from wall outlet before serving milk or food warmed in appliance.
21. Do not leave cord within child's reach.

**CAUTION:** If E1, E2, E3, or E4 error messages appear on the bottle warmer screen, please contact customer service before any continued use of the bottle warmer.



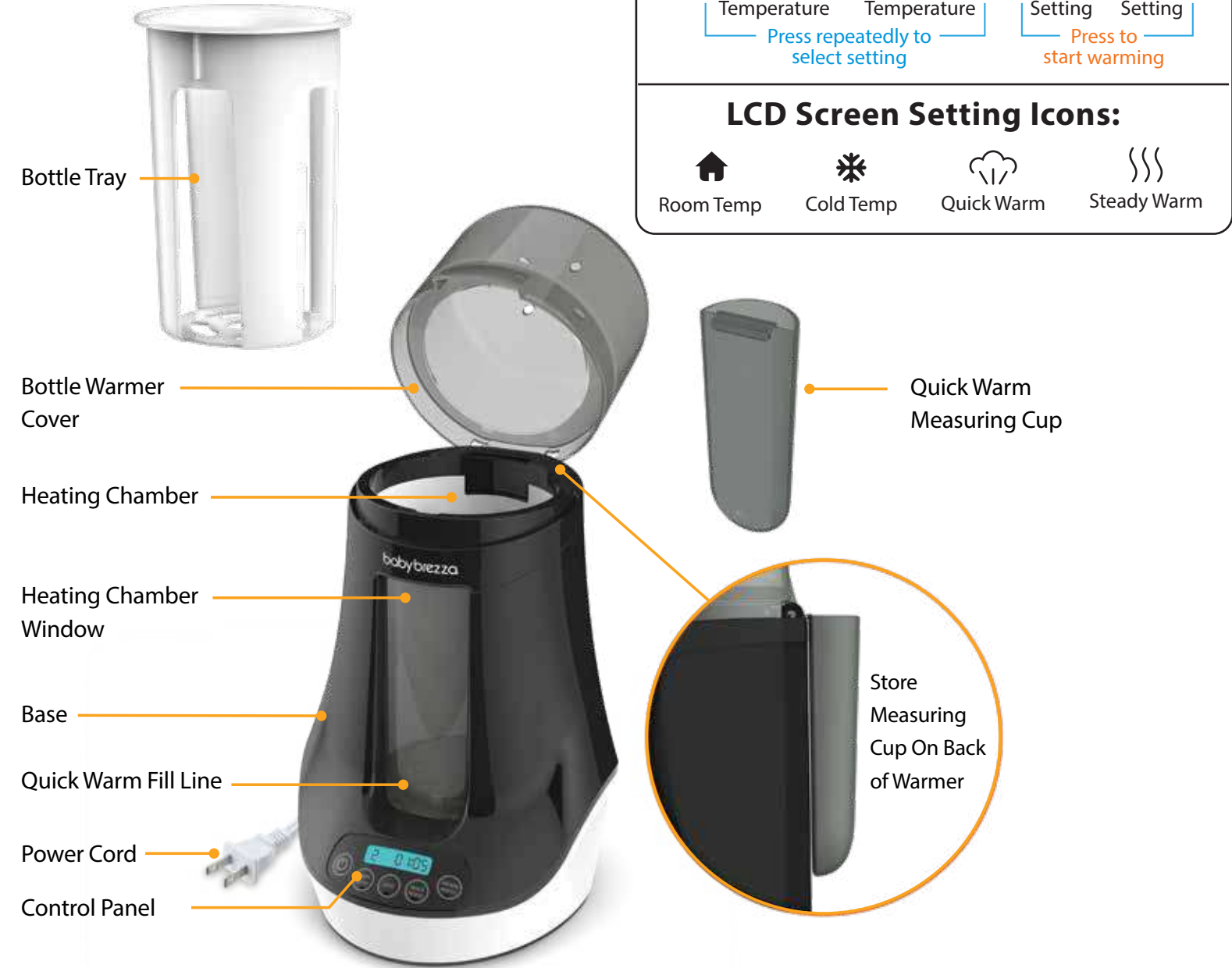

TECHNICAL DATA    Model: BRZ0084    Supply Voltage: 120V ~ 60Hz    Current: 4.4A    Heater Power: 500W

**Save these instructions**

# Bottle + Breastmilk Warmer Parts and Controls



## Steady Warm (ideal for warming breastmilk)





1. Place bottle in the bottle tray and fill the bottle warmer with water until it matches the level of the milk inside the bottle. **Always use room temperature water for best heating results.** Using warm, hot or cold water will result in inaccurate or dangerous bottle temperatures.
2. Close the bottle warmer cover.
3. Press  to turn on machine.
4. Use the setting guide on the back of this manual to determine the setting for your bottle. Make sure to select the correct bottle size and material.
5. Identify the **starting temperature** of your bottle.
  - If your bottle is **room temperature** (approximately 70F/21C) press  repeatedly to select your setting.
  - If your bottle is **cold** (refrigerated 39°F / 4°C) press  repeatedly to select your setting.
6. Press  to begin heating.
7. Warmer will beep when bottle is ready. Remove bottle immediately after warming is complete, swirl bottle gently and check temperature before feeding baby .

**Fill warmer with water to level of milk in the bottle.**

 If you are warming multiple bottles, allow the bottle warmer to cool before warming the next bottle.



## Quick Warm (ideal for warming formula or baby food)

1. Fill the measuring cup (included on the back of the warmer) with **room temperature water**. **Do not use warm, hot or cold water, which will result in inaccurate or dangerous bottle temperatures.** Empty the measuring cup into the warmer as shown.  Water level will be at the "Quick Warm" fill line - see arrow below.
2. Place bottle in the bottle tray and close the bottle warmer cover.
3. Press  to turn on machine.
4. Use the setting guide on the back of this manual to determine the setting for your bottle. Make sure to select the correct bottle size and material.
5. Identify the **starting temperature** of your bottle.
  - If your bottle is **room temperature** (approximately 70F/21C) press  repeatedly to select your setting.
  - If your bottle is **cold** (refrigerated 39°F / 4°C) press  repeatedly to select your setting.
6. Press  to begin heating.
7. Warmer will beep when bottle is ready. Remove bottle immediately after warming is complete, swirl bottle gently and check temperature before feeding baby .

Please note: the quick warm mode uses steam to warm bottles. Please use caution when opening the lid after warming cycle is complete. Always use the bottle tray to remove the bottle from the warmer and avoid touching any hot areas of the bottle warmer. The outside of warmed bottle may be hot immediately after warming.

**Fill warmer with water to the Quick Warm Fill line.**  
(use measuring cup included with warmer)

 If you are warming multiple bottles, allow the bottle warmer to cool before warming the next bottle.





## Defrosting Frozen Milk Pouches

To use the defrost setting, place a frozen milk pouch into the warmer and fill water to the line of the milk in the pouch.

Press the **cold** temperature setting until the "F" icon is displayed on the LCD screen,

Then press **steady warm** to begin heating.



## Cleaning the Bottle Warmer

Always allow warmer to cool before cleaning



1  
Unplug the bottle warmer and remove the bottle tray from the base.



2  
Carefully pour out any remaining water inside the base.



3  
Wipe all parts dry before next use. If necessary, wipe base exterior with damp cloth. **Do not use scouring pads, abrasives or solvents for cleaning.**

## Descaling the Bottle Warmer

It is very important to descale this appliance every 4 weeks to ensure that it continues to work properly.

Pour all remaining water out of the water chamber. To descale, mix 2oz (60ml) of white vinegar with 4oz (120ml) of cold water into the water chamber, and then run one heating cycle on setting 5 until any scaling has been removed. Please ensure proper ventilation when descaling with vinegar.

## Troubleshooting

Condition	Possible Cause	Possible Remedy
Unit will not power on.	Unit is unplugged.	Ensure that plug is securely inserted into the power outlet.
	⏻ is held for too long.	Press ⏻ to turn on the unit. Do <b>not</b> hold down the button.
Lid will not close.	Bottle Tray is misaligned inside bottle warmer.	Ensure that bottle tray is lined up with bottle tray slots in the bottle warmer.
Warmed bottle is too hot. (Quick warm setting)	Not enough water added to bottle warmer.	Add water to the marked Quick Warm fill line.
	Setting time is too long or incorrect setting chosen.	Try a lower setting according to your preference.
Warmed bottle is too hot. (Steady warm setting)	Not enough water added to bottle warmer.	Add water until it matches the height of liquid in your bottle.
	Setting time is too long or incorrect setting chosen.	Try a lower setting according to your preference.
Warmed bottle is too cold. (Quick & Steady warm settings)	Too much water added to bottle warmer.	Reduce water in bottle warmer to the required height based on your setting. (Refer to page 5).
	Setting time is too short or incorrect setting chosen.	Try a higher setting according to your preference.
"E5" error displays on machine or "Error" message displays on app.	Little or no water has been added to the machine.	Add cold water to the machine and let it sit and cool for 5 min. Empty out cold water and restart the bottle warmer. Make sure to add the appropriate amount of water needed for warming.
E1, E2, E3, or E4 error displays on machine.	Internal malfunction in machine.	Please contact customer service before continuing to use your machine.

If you can not remedy problems by using the troubleshooting chart above, do not return your bottle warmer to the store, please contact Customer Service at 1-888-396-6552. Any other servicing should be performed by an authorized service representative.

### LIMITED 1-YEAR WARRANTY

The limited warranty is valid only on products bought through authorized resellers and used in the United States and Canada. Buying through an unauthorized reseller or using this product outside of the United States and Canada automatically voids this warranty.

This warranty is available to consumers only. You are a consumer if you own a Baby Brezza Safe + Smart Bottle Warmer that was purchased at retail for personal, family or household use. Except as otherwise required under applicable state law, this warranty is not available to retailers or other commercial purchasers or owners. We warrant that your Baby Brezza Safe + Smart Bottle Warmer will be free of defects in material or workmanship under normal home use for one year from the date of original purchase. Customer will be required to present original proof of purchase in order to obtain the warranty benefits. In the event that you do not have proof of purchase date, the purchase date for purposes of this warranty will be the date of manufacture. If your Baby Brezza Safe + Smart Bottle Warmer should prove to be defective within the warranty period, we will repair it or, if we consider it necessary, replace it. To obtain warranty services, please call Customer Service at: 1-888-396-6552, customerservice@babybrezza.com or write to: Baby Brezza, 250 Passaic Street, Newark, NJ 07104 Attn: Customer Service.

Warning: Changes or modifications to this unit not expressly approved by the party responsible for compliance could void the user's authority to operate the equipment.